

Creemore Sewage Treatment Plant New Equalization Tank

Clearview Township



**Municipal Class Environmental Assessment
Public Information Centre October 28, 2009**

Welcome

Purpose of today's Information Centre:

- To describe the proposed project and problem/opportunity statement
- To present alternative solutions and identify a preliminary preferred solution
- To encourage, gather and respond to public input and feedback
- To identify next steps in the process

Please.....

- Ask us any questions you may have about the project or the results / scope of study
- Fill out a comment sheet and leave it with us – or take it home and return it later (by November 11, 2009) to the address provided



Introduction / Problem Statement

The average daily flows from the Creemore community service area are adequately accommodated by the existing Creemore Sewage Treatment Plant. Occasionally, high extraneous and infiltration flows from the collection system have exceeded the hydraulic capacity of the plant. Generally, these high flows are experienced during the spring months. This has resulted in the periodic need to truck sewage off-site to other treatment facilities.

Clearview Township has identified the need for storage capacity to accommodate existing peak flows.

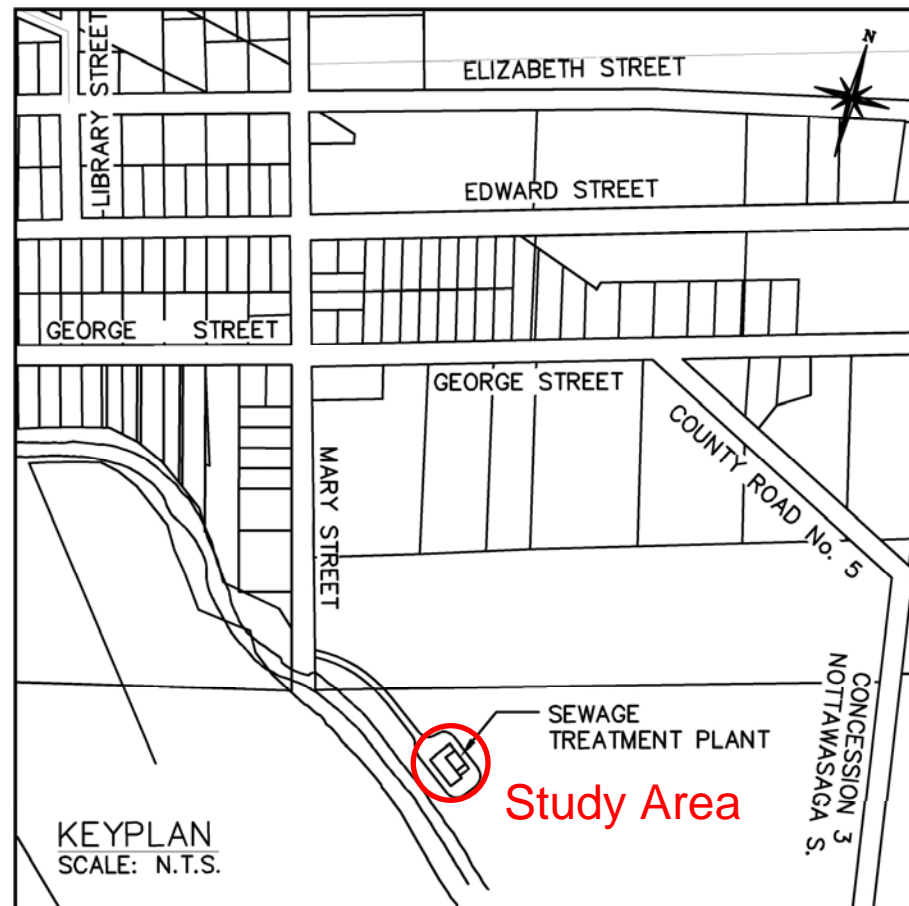

Municipal Class EA Process

NOTE: This flow chart is to be read in conjunction with Part A of the Municipal Class EA

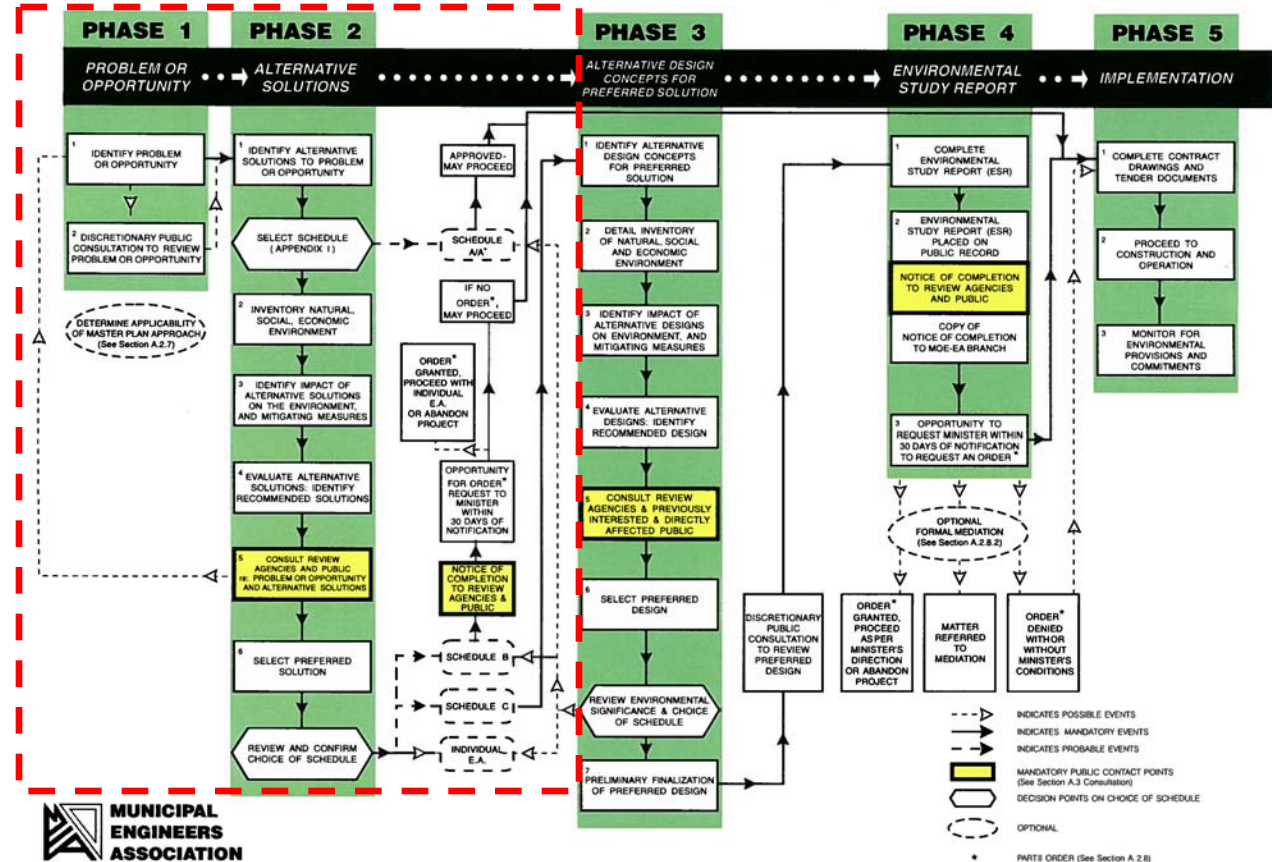

This project will be carried out in accordance with the Schedule 'B' requirements of the Municipal Class EA (MEA, October 2007).

Phases 1 and 2 of the EA process will be followed. →

Alternative Solutions

- Do Nothing
- Improve operation/maintenance of existing system
- Expand existing sewage plant capacity to accommodate peak flows
- Implement on-site storage to manage peak flows



Evaluation of Solutions

- Do Nothing – Does not solve the problem. Potential risk of impact to natural environment if sewage overages cannot be managed under regular plant operations. Unknown operational costs due to unpredictability of off-site sewage trucking requirements.
- Improve operation/maintenance of existing system - Can form part of ongoing solution for addressing extraneous flows in system, however does not address the problem alone. High costs associated with ongoing study and system upgrades.
- Expand existing sewage plant capacity to accommodate peak flows – Potential for impacts to natural environment. Temporary noise impacts associated with construction. Significant costs and time prohibitive.
- Implement on-site storage to manage peak flows – Will provide long-term solution to manage extraneous flows. Minimal potential for impacts to natural environment. Temporary noise impacts associated with construction. Can be integrated with other plant structures. Moderate costs.

Preliminary Preferred Solution

The preliminary preferred solution is to **implement on-site storage** at the existing sewage treatment plant to manage extraneous flows. This solution can be implemented within a relatively short period of time and will provide long-term capacity for addressing extraneous flows.

The preliminary preferred design option is an **equalization tank**. A lagoon system was considered, however this is not feasible given the high water table at the site. The equalization tank will serve as an important operational component to the overall sewage treatment plant.

In addition to the implementation of on-site storage, the Township will continue its efforts to reduce extraneous flows.

CONCEPTUAL OPTION No. 1

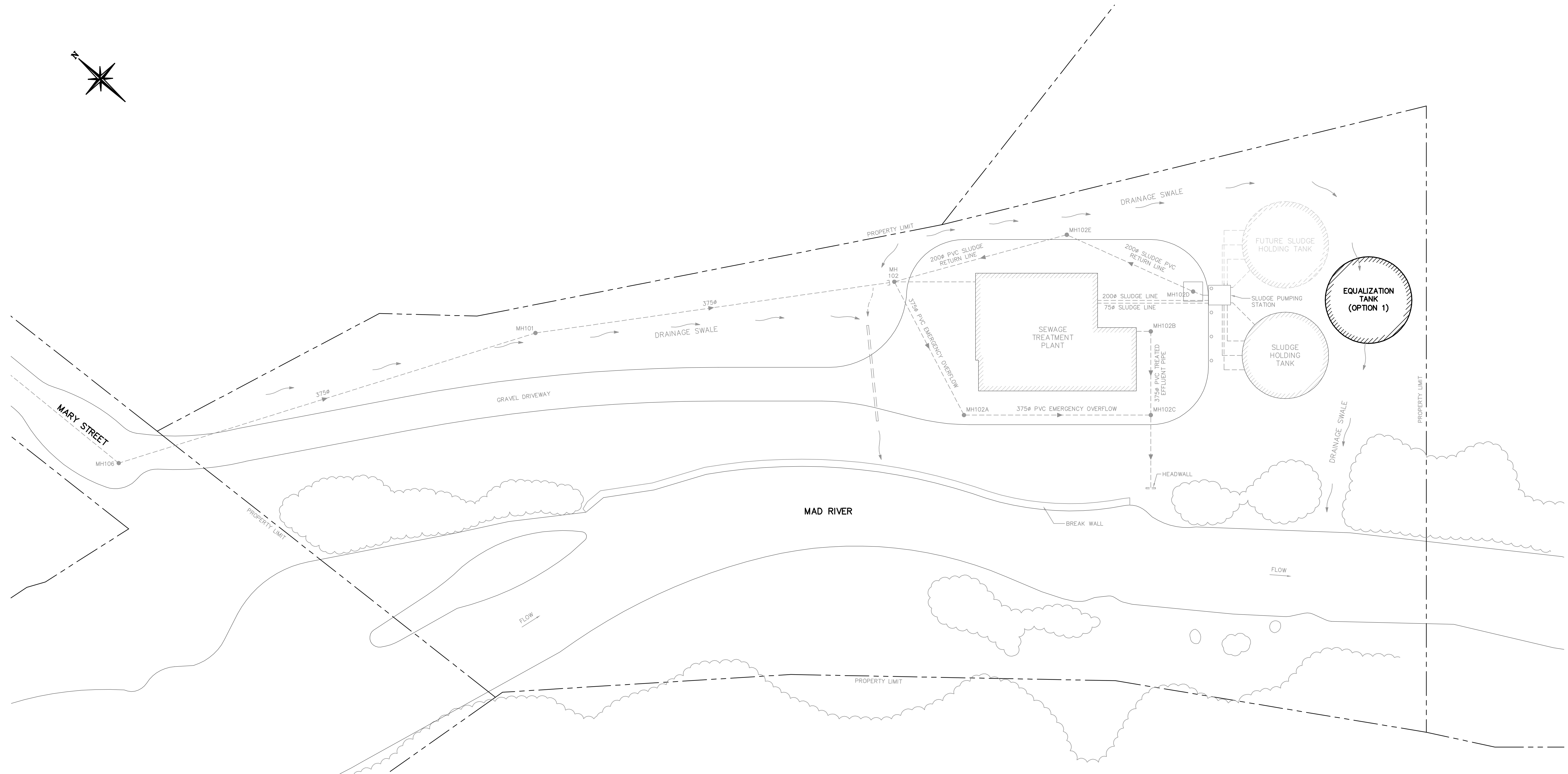
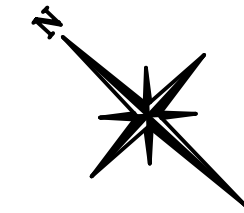

1. This drawing is the exclusive property of R. J. Burnside & Associates Limited and the reproduction of any part without prior written consent of this office is strictly prohibited.

2. The contractor shall verify all dimensions, levels, and datums on site and report any discrepancies or omissions to this office prior to construction.

3. This drawing is to be read and understood in conjunction with all other plans and documents applicable to this project.

No.	Issue / Revision	Date
1	PUBLIC INFORMATION CENTER (PIC)	OCTOBER 2009

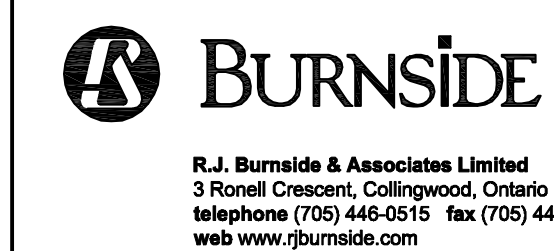

TOWNSHIP OF CLEARVIEW
 COUNTY OF SIMCOE
 P.O. BOX 200
 217 GIDEON STREET
 STAYNER, ONTARIO
 L0M 1S0

Drawing Title			
CLEARVIEW SEWAGE TREATMENT PLANT UPGRADES			
EQUALIZATION TANK LOCATION OPTION 1 PLAN			
Drawn	Checked	Designed	Checked
J.R.	K.K.		
Scale	Project No.	Drawing No.	
1:400	MCG16732	P1	

CONCEPTUAL OPTION No. 2

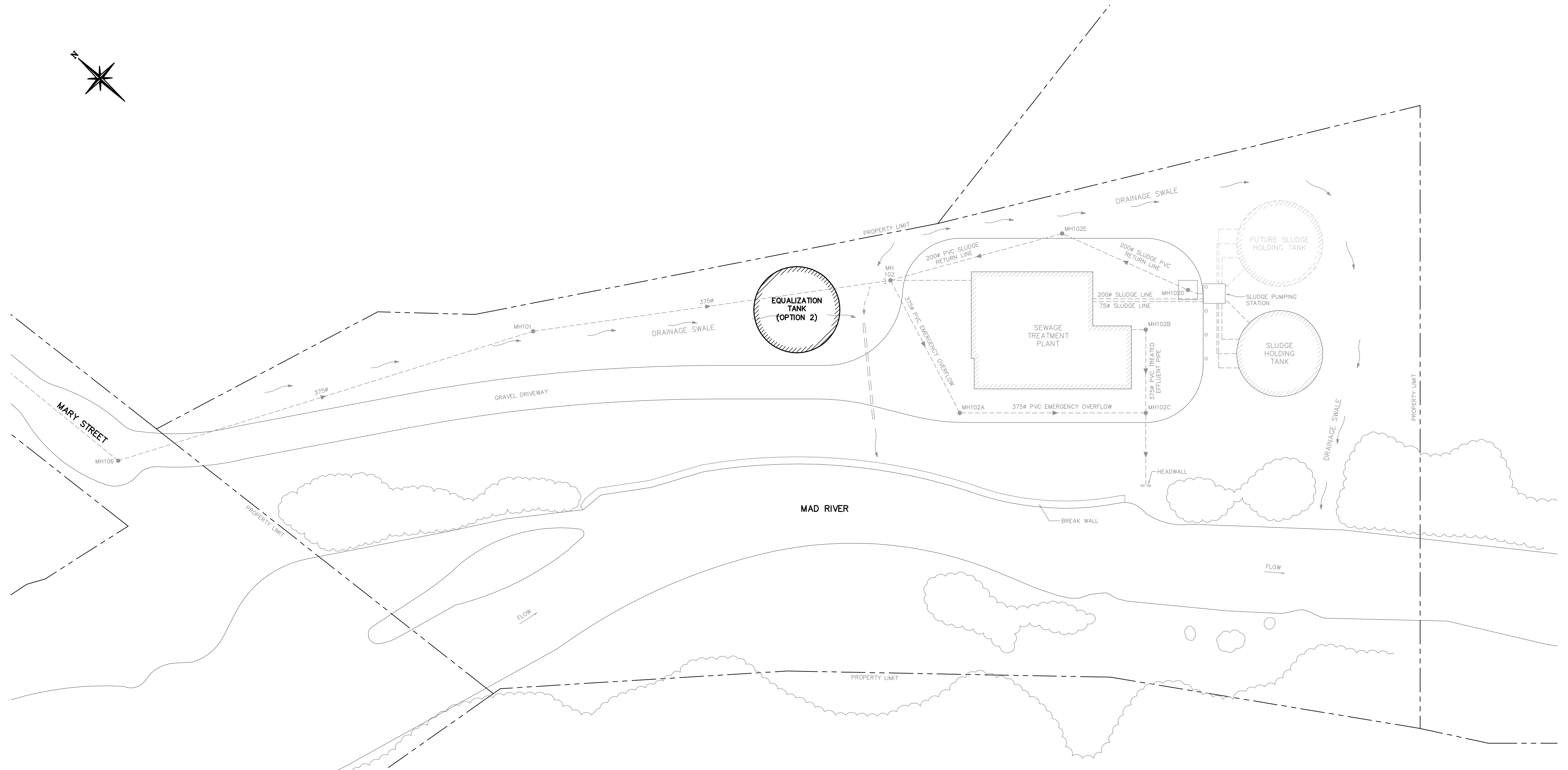
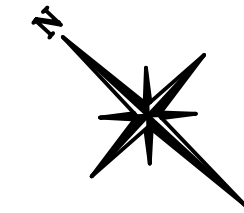

1. This drawing is the exclusive property of R. J. Burnside & Associates Limited and the reproduction of any part without prior written consent of this office is strictly prohibited.

2. The contractor shall verify all dimensions, levels, and datums on site and report any discrepancies or omissions to this office prior to construction.

3. This drawing is to be read and understood in conjunction with all other plans and documents applicable to this project.

No.	Issue / Revision	Date
1	PUBLIC INFORMATION CENTER (PIC)	OCTOBER 2009

BURNSIDE
 R.J. Burnside & Associates Limited
 3 Ronell Crescent, Collingwood, Ontario
 telephone (705) 446-0515 fax (705) 446-2399
 web www.rjburnside.com

TOWNSHIP OF CLEARVIEW
 COUNTY OF SIMCOE
 P.O. BOX 200
 217 GIDEON STREET
 STAYNER, ONTARIO
 L0M 1S0

Drawing Title				Rev
CLEARVIEW SEWAGE TREATMENT PLANT UPGRADES				0
EQUALIZATION TANK LOCATION OPTION 2 PLAN				
Drawn	Checked	Designed	Checked	Drawing No.
J.R.	K.K.			P2
Scale	Project No.			
1:400	MCG16732			

CONCEPTUAL OPTION No. 3

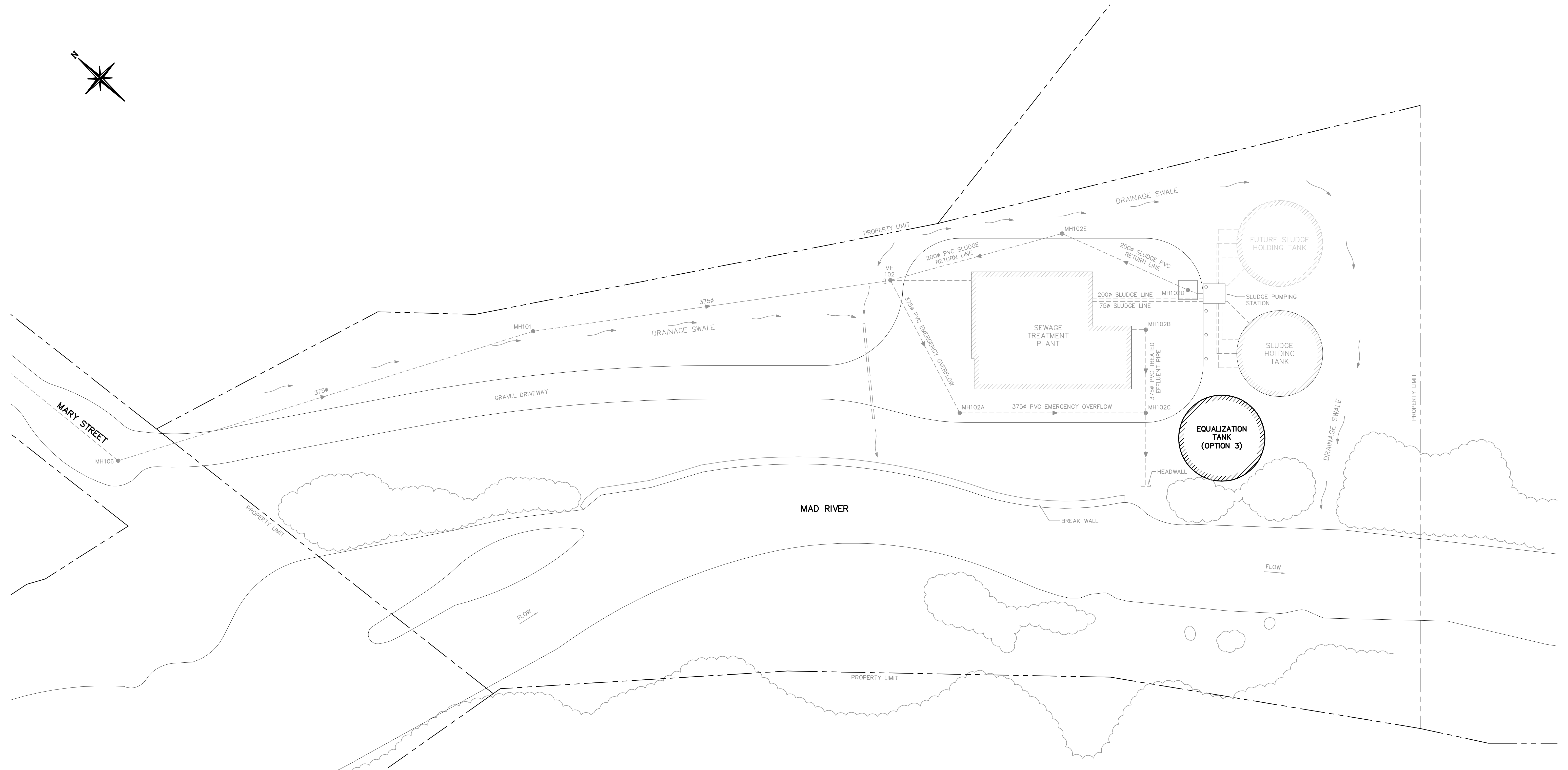
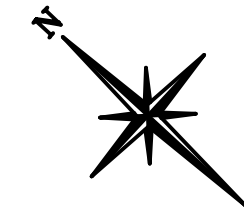

1. This drawing is the exclusive property of R. J. Burnside & Associates Limited and the reproduction of any part without prior written consent of this office is strictly prohibited.
 2. The contractor shall verify all dimensions, levels, and datums on site and report any discrepancies or omissions to this office prior to construction.
 3. This drawing is to be read and understood in conjunction with all other plans and documents applicable to this project.

No.	Issue / Revision	Date
1	PUBLIC INFORMATION CENTER (PIC)	OCTOBER 2009

BURNSIDE
 R.J. Burnside & Associates Limited
 3 Ronell Crescent, Collingwood, Ontario
 telephone (705) 446-0515 fax (705) 446-2399
 web www.rjburnside.com

TOWNSHIP OF CLEARVIEW
 COUNTY OF SIMCOE
 P.O. BOX 200
 217 GIDEON STREET
 STAYNER, ONTARIO
 L0M 1S0

Drawing Title				Rev
CLEARVIEW SEWAGE TREATMENT PLANT UPGRADES				0
EQUALIZATION TANK LOCATION OPTION 3 PLAN				
Drawn	Checked	Designed	Checked	Drawing No.
J.R.	K.K.			P3
Scale	Project No.			
1:400	MCG16732			

CONCEPTUAL OPTION No. 4

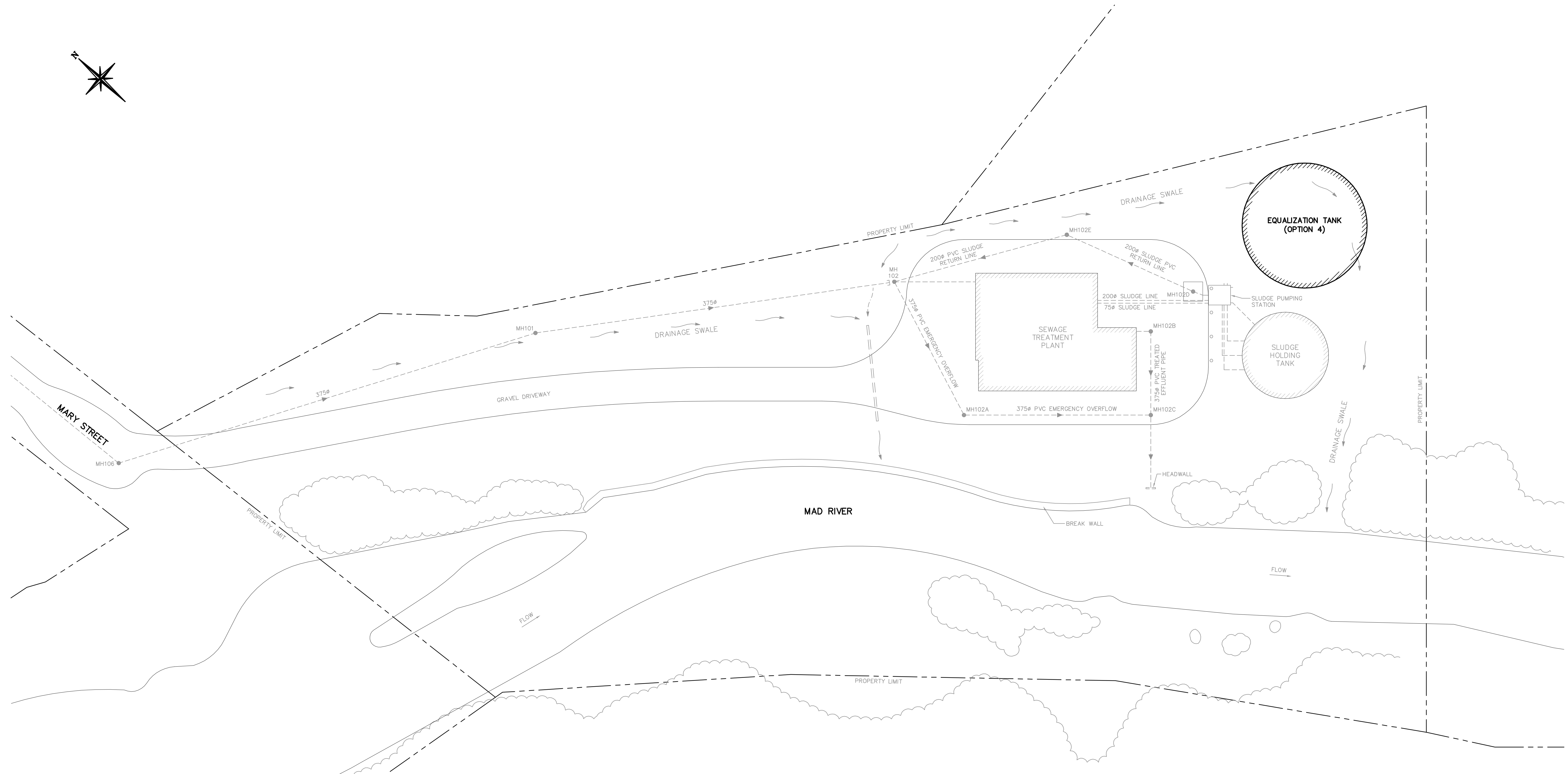
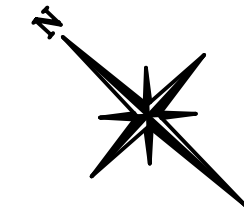

1. This drawing is the exclusive property of R. J. Burnside & Associates Limited and the reproduction of any part without prior written consent of this office is strictly prohibited.
 2. The contractor shall verify all dimensions, levels, and datums on site and report any discrepancies or omissions to this office prior to construction.
 3. This drawing is to be read and understood in conjunction with all other plans and documents applicable to this project.

No.	Issue / Revision	Date
1	PUBLIC INFORMATION CENTER (PIC)	OCTOBER 2009

BURNSIDE
 R.J. Burnside & Associates Limited
 3 Ronell Crescent, Collingwood, Ontario
 telephone (705) 446-0515 fax (705) 446-2399
 web www.rjburnside.com

TOWNSHIP OF CLEARVIEW
 COUNTY OF SIMCOE
 P.O. BOX 200
 217 GIDEON STREET
 STAYNER, ONTARIO
 L0M 1S0

Drawing Title				Rev
CLEARVIEW SEWAGE TREATMENT PLANT UPGRADES				0
EQUALIZATION TANK LOCATION OPTION 4 PLAN				
Drawn	Checked	Designed	Checked	Drawing No.
J.R.	K.K.			P4
Scale	Project No.			
1:400	MCG16732			

Potential Impacts/Mitigation Measures

Surface Water Quality

- *Impact:* Potential for sediments to enter watercourse as a result of restoration activities. Potential for localized water quality impacts as a result of spills.
- *Mitigation:* The footprint of the disturbed area will be minimized as much as possible. Erosion and sediment control measures meeting or exceeding the Towns requirements are to be installed on-site and maintained through the duration of the project. The contractor will be required to develop a spills prevention and contingency plan.

Dust/Noise/Air Quality

- *Impact:* Temporary nuisance noise during construction activities.
- *Mitigation:* Noise control measures, such as restricted hours of operation and the use of appropriate machinery / mufflers, will be enforced.

Health & Safety

- Contractor will be required to implement a Health & Safety Plan.



Next Steps

- Review and finalize preferred solution in light of comments received
- Finalize the Project File Report (PFR) and Notice of Study Completion (30-day review period)
- Prepare Detailed Designs
- Obtain Any Permits/Approval
- Construction



Your On-Going Involvement is Important to Us

- There is an opportunity at any time during the EA process for interested persons to provide comment. Our team welcomes any comments that you may have about this project, either at the Information Centre or through correspondence, so that your input can be incorporated into the study process.
- Comment sheets are available and should be submitted to the address provided by November 11, 2009.

