

Fee	Receipt	Permit	Expiry Date
\$	#	#	

Applicant Information

Name	
Mailing Address	
Phone Number	
Email	

Property Owner Information (if different from above)

Name	
Mailing Address	
Phone Number	
Email	

Garden Encroachment Details

Municipal Address	
Proposed Install Date	
Description of proposed garden (i.e. types of plants):	

Application Requirements

- ☐ Detailed plan or sketch on a minimum of 8.5" x 11" paper showing:
 - the proposed boulevard garden, including dimensions and its location relative to fixed features, and delineating anysight triangle restrictions;
 - all topographical features;
 - all boundary lines for the lots abutting the garden;
 - street names and municipal addresses; and
 - north arrow depicting true north.
- ☐ Property owner's consent (if applicant is different)
- ☐ Sight triangles clearly marked with stakes for inspection purposes

Local – Local Road	Local – Collector Road
3m x 3m at intersection	3m x 7.5m at intersection
3m x 3m at driveway	3m x 3m at driveway

The applicant understands that all works will be constructed, altered, maintained, or operated at the expense of the undersigned and that work must not begin before a permit has been issued by the Township.

The applicant has read all the requirements outlined under By-law 25-40 including the following:

- Plant material not in a sight triangle shall not exceed 1 metre in height.
- Plant material in a sight triangle shall not exceed 0.6 m.
- fire hydrants must be easily viewable and accessible. Any plant material within a 1.5m radius of the fire hydrant shall be no higher than 15cm.
- No plant material of any kind shall be planted within 1 m of a utility structure.
- Plants shall not overhang the sidewalk or path or pose a hazard to pedestrians or other users of same.
- Plant material shall not interfere with proper water flow or proper draining, including but not limited to within roadside ditches and drainages swales.
- No plants of any kind, with the exception of grass, shall be planted, grown or maintained within a 1 m radius of any Boulevard tree.
- No garden shall have permanent fixtures, chattels, equipment or any non-plant installations, including but not limited to below surface irrigation systems, raised planters or other above-ground planting structures, any hardscaping materials or landscaping stones, any garden or outdoor furniture or any railings, hoarding or fencing.
- The issuance of a permit by the Township does not relieve the holder the responsibility of complying with other relevant municipal by-laws.

In consideration of any permit issued in respect to this application, we the applicants ourselves, our heirs, executors, administrators, successors, and assigns hereby agree to observe, keep and perform and be subject to the regulations and conditions of the said permit and to indemnify and save harmless, the Township of Clearview represented by the Director of Public Works from and against all loss, cost, charges, damages, expenses, claims, and demands whatsoever to which may be put or which the Township of Clearview may suffer or sustain or for which the Township of Clearview may be liable by reason of anything done or omitted to be done in the construction, maintenance, alteration or operation of the works authorized.

Applicant signature: _____ Date: _____

Notice with respect to Collection of Personal Information

This information is collected under the legal authority of the Municipal Act, 2001, S.O. 2001, c. 25. The information will be used in respect to reviewing the application and issuing a boulevard garden permit.

Personal Information will be disclosed to the Public Works Department and By-law Enforcement in accordance with the Municipal Freedom of Information and Protection of Privacy Act, R.S.O. 1990, c. M. 56 as amended. For more information, please contact: Dan Perreault, Director of Public Works (705) 424-0140 ext. 606

Township Use Only

Date Inspected:		
Sight Triangle Required:		
Special Comments:		
Inspected By:		Date:
Approved By:		Date:

Driveway Sight Triangle

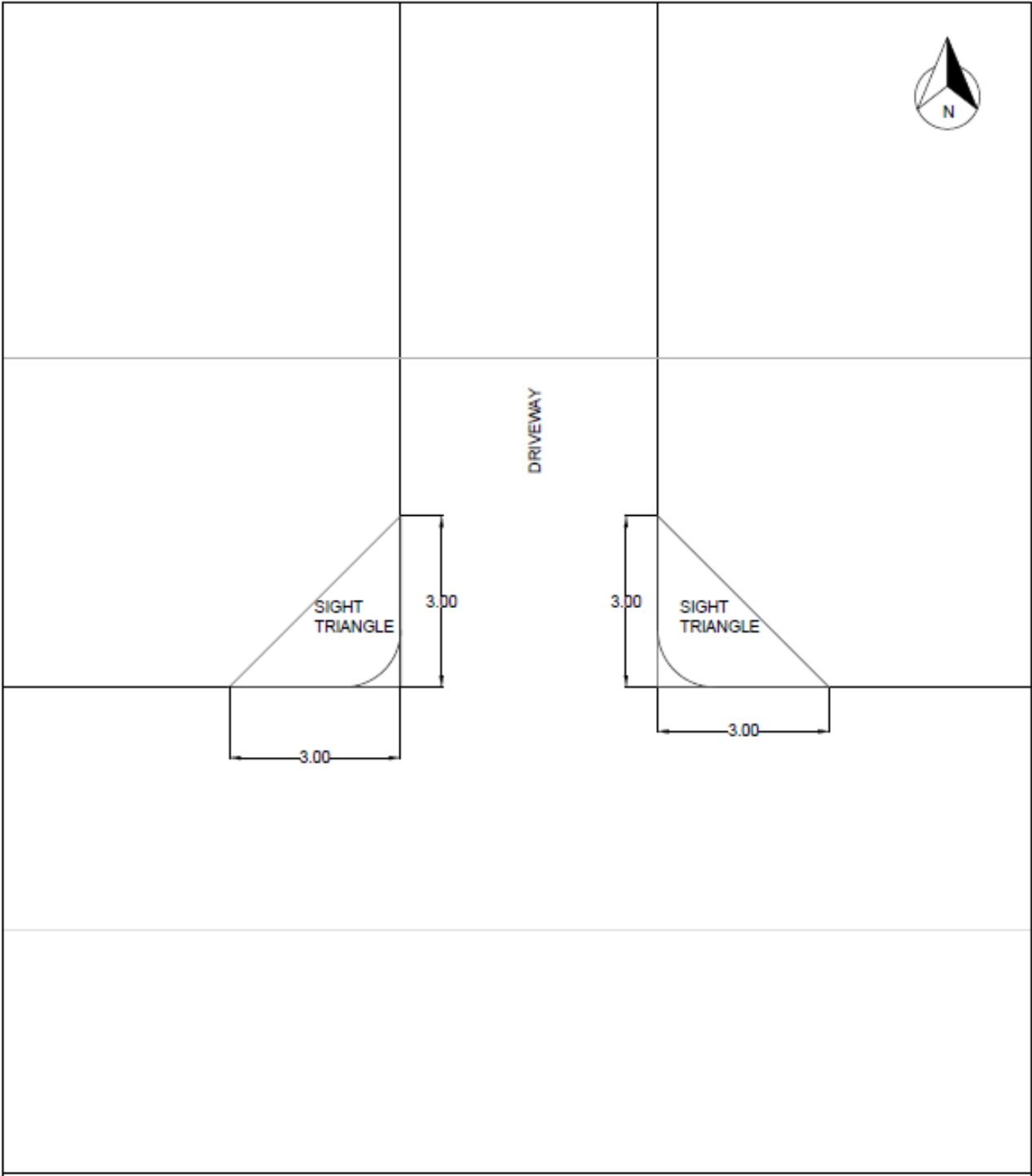

Local to Local Road Sight Triangle

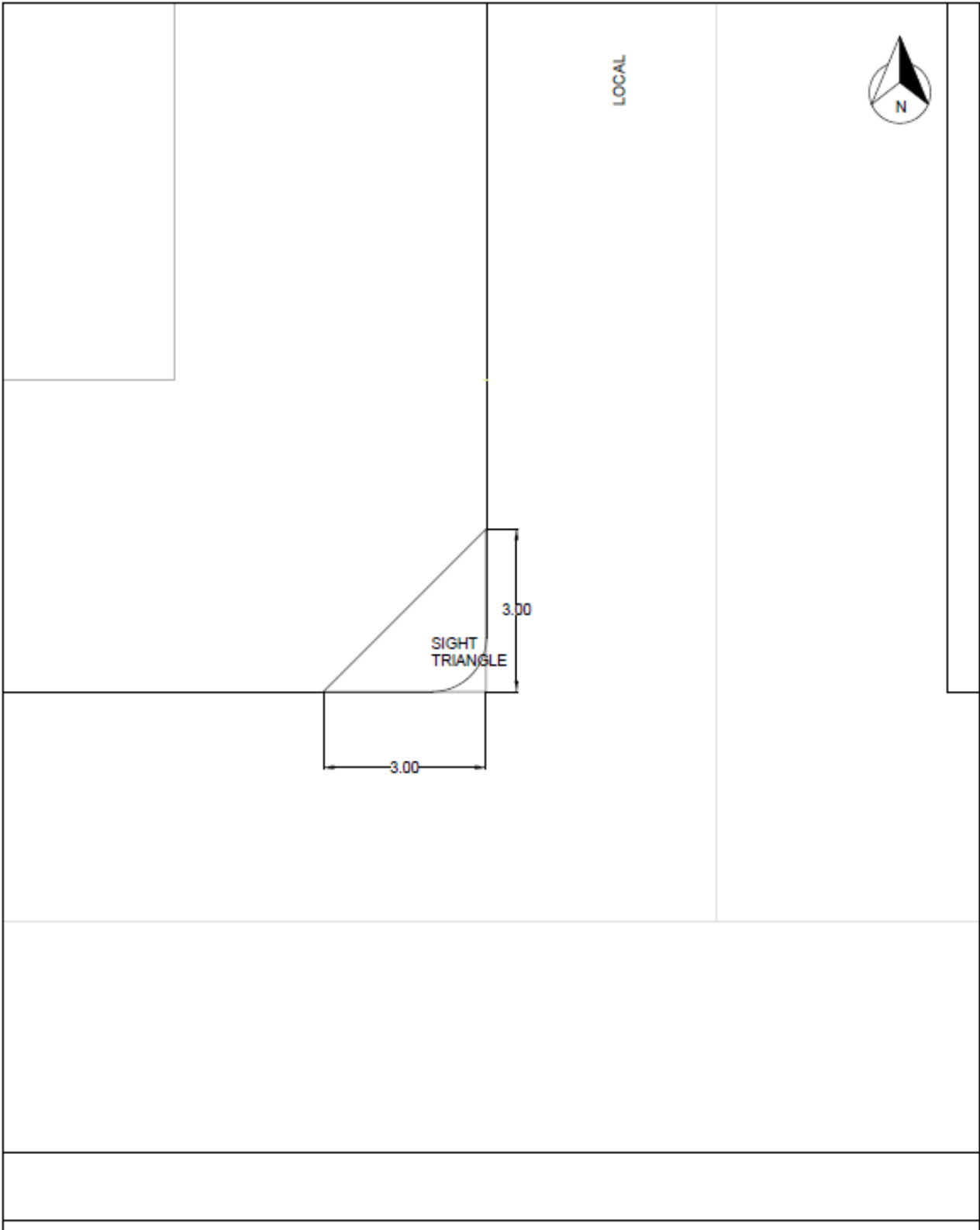

Collector of Local Road Sight Triangle

