

# CREEMORE OUTDOOR SPORTS PARK

## County of Simcoe - Web Map

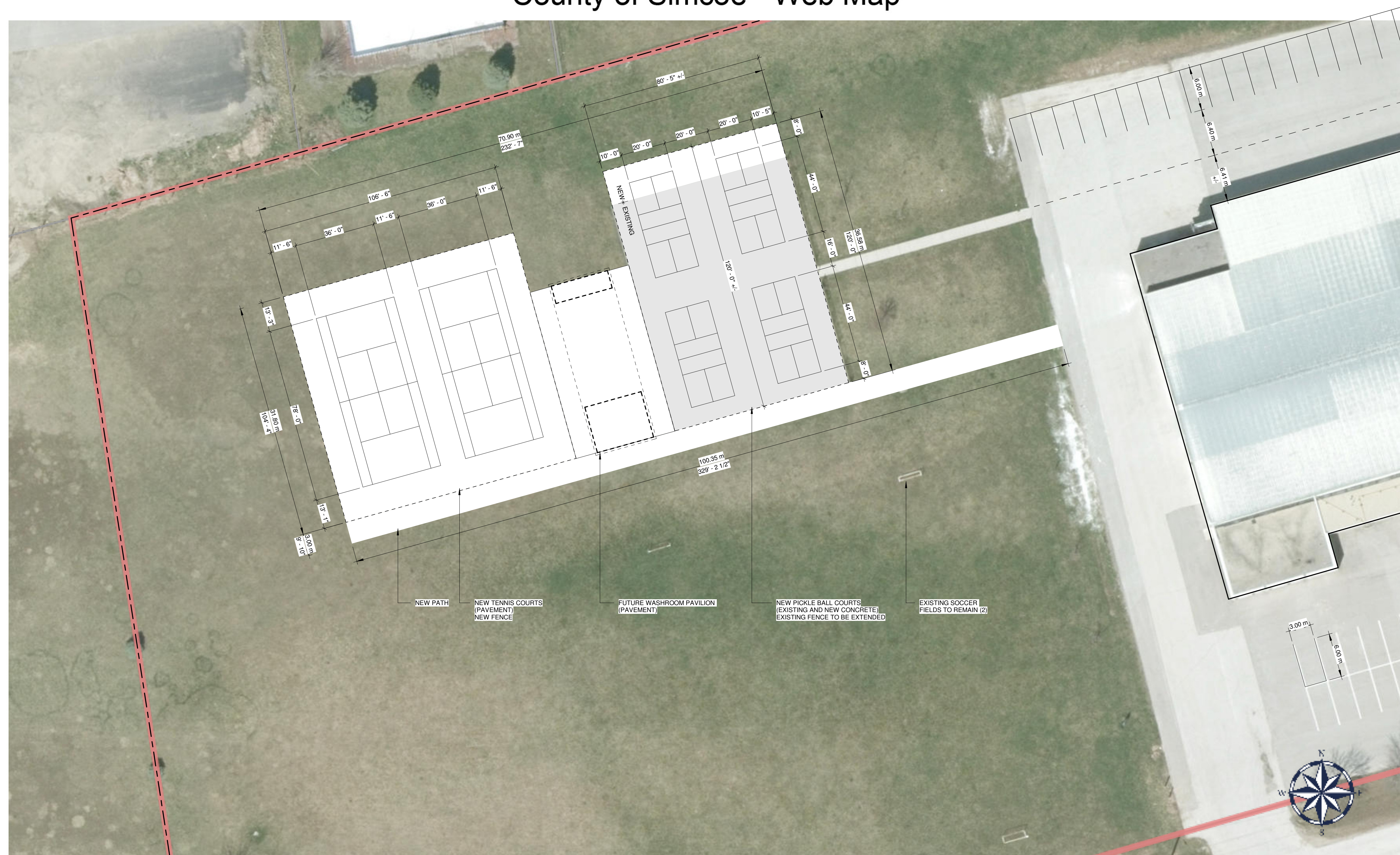

**GENERAL NOTES**

ALL DRAWINGS ARE THE PROPERTY OF THE ARCHITECT. REPRODUCTION OF DRAWINGS WITHOUT WRITTEN PERMISSION OF THE ARCHITECT IS PROHIBITED.

THE GENERAL CONTRACTOR SHALL CHECK AND VERIFY ALL DIMENSIONS BEFORE PROCEEDING WITH THE WORK. ANY DISCREPANCIES SHALL BE REPORTED TO THE ARCHITECT IMMEDIATELY.

ALL WORK SHALL CONFORM TO THE LATEST EDITION OF THE ONTARIO BUILDING CODE.

IT IS THE RESPONSIBILITY OF THE GENERAL CONTRACTOR TO COORDINATE ALL STRUCTURAL, MECHANICAL AND ELECTRICAL WORK.

No.	Description	Date
1	Issued for Client Review	10 Mar 25
2	Orientation Revision	24 Mar 25

This map, either in whole or in part, may not be reproduced without the written authority from © The Corporation of the County of Simcoe. This map is intended for personal use, has been produced using data from a variety of sources and may not be current or accurate. Produced (in part) under license from: © His Majesty the King in Right of Canada, Department of Natural Resources: © King's Printer, Ontario Ministry of Natural Resources: © Teranet Enterprises Inc. and its suppliers: © Members of the Ontario Geospatial Data Exchange. All rights reserved. THIS IS NOT A



**TED HANDY and ASSOCIATES**  
Inc. ARCHITECT

76 Mary Street  
Barrie, Ont L4N 1T1

Tel. 705 734 3580  
Fax 705 721 0265

**Outdoor Sports Park**  
Creemore, ON

**Site Plan**

Project number 2432

**A1.0**

Scale 1 : 300

1 Site - Option 1

2025-03-24 3:59:04 PM